

- NOTES**
- THIS DRAWING IS TO BE READ IN CONJUNCTION WITH ALL OTHER RELEVANT ENGINEERING DRAWINGS. ANY DISCREPANCIES, ERRORS OR OMISSIONS TO BE BROUGHT TO THE ATTENTION OF THE EMPLOYER.
 - ALL DIMENSIONS TO BE CHECKED BY THE CONTRACTOR ON SITE PRIOR TO COMMENCEMENT OF WORKS.
 - EMPLOYER'S REPRESENTATIVE TO BE INFORMED BY THE CONTRACTOR OF ANY DISCREPANCIES PRIOR TO THE COMMENCEMENT OF WORKS ON SITE.
 - DIMENSIONS OF ALL BOUNDARIES AND ADJOINING ROADS TO BE CHECKED ON SITE PRIOR TO COMMENCEMENT OF WORKS.
 - DO NOT SCALE. ALL MEASUREMENTS AND COORDINATES TO BE CHECKED ON SITE.
 - EXISTING FENCE LINES ARE INDICATIVE AND ARE TO BE CONFIRMED ON SITE. EXISTING FENCING IS TO BE REVIEWED ON SITE AND REPLACED WHERE REQUIRED.
 - EMERGENCY ACCESS POINTS ARE TO BE CLOSED OFF WITH DEMOUNTABLE BOLLARDS. KEYS TO BE HANDED OVER TO THE OVERSEEING ORGANISATION.
 - EGREENWAY DRAINAGE IS TO BE OVER THE EDGE DRAINAGE
 - PROPOSED FENCELINE TO BE ERECTED IN ACCORDANCE WITH TII STANDARD DETAIL CC-SCD-00303

ISSUE/REVISION

I/R	DATE	DESCRIPTION
D	DEC 2023	ABP RFI UPDATE
C	MAY 2023	ABP RFI UPDATE
B	MAY 2020	ISSUED FOR INFORMATION
A	APRIL 2020	ISSUED FOR INFORMATION

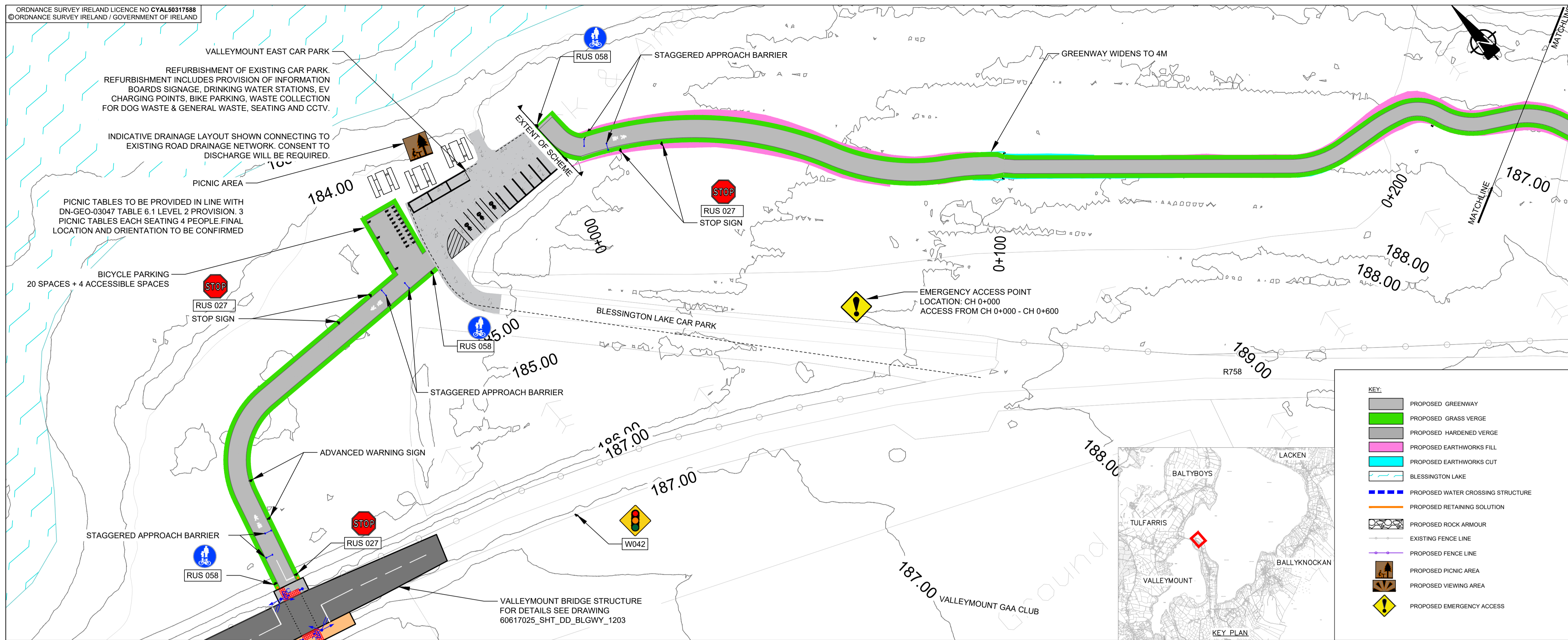

PHASE 1 - CL LONGSECTION
SCALE: H 1:1000, V 1:200

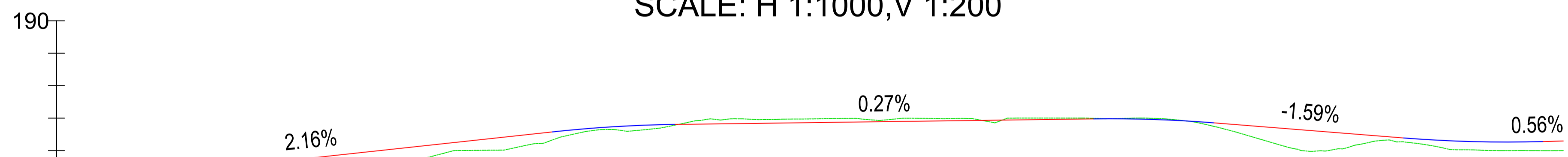

CHAINAGE	00.000	50.000	100.000	150.000	200.000	230.000
EXISTING LEVELS	184.978	185.548	186.941	187.002	186.249	185.997
PROPOSED LEVELS		186.056	186.823	186.956	186.473	186.295
VERTICAL ALIGNMENT		G=2.16% 1:46.3	L=18.94 K=10.00	G=0.27% 1:375.8	L=18.57 K=10.00	G=-1.59% -1:62.9
					L=21.502 K=10.00	G=0.56% 1:178.7

This drawing has been prepared for the use of AECOM's client. It may not be used, modified, reproduced or relied upon by third parties, except as agreed by AECOM or as required by law. AECOM accepts no responsibility, and denies any liability, whatsoever, to any party that uses or relies on this drawing without AECOM's express written consent. All measurements must be obtained from the stated dimensions.